



## YC-DMX.16A 16 CH DMX Dimming and Color Tuning Module

### Product Manual

Release : September 22, 2023

Version : V2.0



Figure 1. 16 CH DMX Dimming and Color Tuning Module

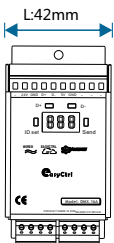

Figure 2. Dimensional Drawing - Front View

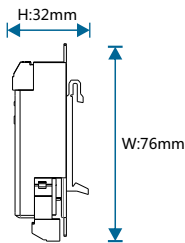

Figure 3. Dimensional Drawing -Sideview

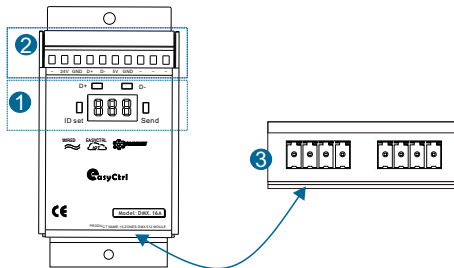

Figure 4. Product Information

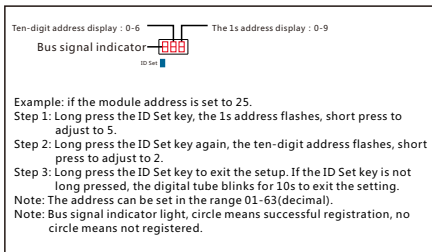

Figure 5. Address setup instructions

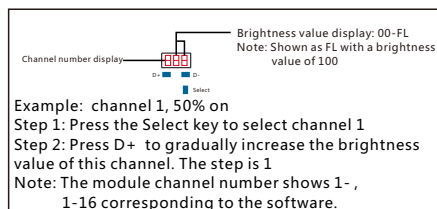

Figure 6. Manually testing data sending

## Product Overview

16 CH DMX Dimming and Color Tuning Module (see Figure 1), serve as a system dimmer execution unit, typically installed in a distribution box, rail type or wall-mounted installation, occupies 2.5P module units. It can control 16 DMX channels, real-time feedback of each loop state; Realize the control of RGB light switch, dimmer, color matching, DMX wall washing lamp, moving head lamp and other equipment.

## Function Description

- Standard 35mm DIN rail installation: Occupies 2.5P module units.
- Provide 16 sets of DMX512 signal address, each channel can independently control 0-100 brightness value, and with feedback
- Returns the actual DMX dimmer status of each circuit to the monitoring center immediately after executing scene commands.
- With local and remote programming and testing functions.
- Supports online firmware updates and Bus network disconnection alarm function.
- Supports YC-BUS communication.

## Precautions

- Use RVV4\*0.75 four-core wire for bus wiring.
- Do not connect the D+ and D- signals of the bus interface incorrectly; otherwise, the bus signals will be abnormal.

## Product Information

Product Dimensions: See Figures 2 and 3

Product Wiring: See Figure 7 and 8

Product Information: See Figure 4

1. Function Keys:

- ID Set key : Address setting 01-63, setting method (see Figure 5).
- D+ key : Long press the brightness value gradually increase.
- D- key : Long press the brightness value gradually decreasing.
- Select key : Short press to select the DMX512 channel.

2. DMX512 interface : 24V and 5V are the output voltages (see Figure 7).

3. Bus interface (see Figure 8) :

- Bus interface line sequence: 24V, GNG, A, B

## Product Installation

See Figures 9-11

- Step 1. Secure the 35mm rail with screws.
- Step 2. Hold the 16 CH DMX Dimming and Color Tuning Module at a 45 degree angle with both hands, and the bottom of the module is clamped against the guide rail. The whole module is pressed to the guide rail at a 90 degree angle, and the module is slid until it is in the correct position.



## Safety Warning

- Tightening torque should not exceed 0.4 Nm.
- Installation location: Distribution box.
- Do not connect the YC-BUS interface incorrectly, as it may damage the equipment.
- The YC-BUS interface must not be connected to AC power; otherwise, it will damage all devices on the bus.
- Ensure a good ventilation environment.
- Do not expose to rain, contact with other liquids, or corrosive gases.

## Packing List

- YC-DMX.16A\*1/User Manual\*1/Certificate of Conformity\*1

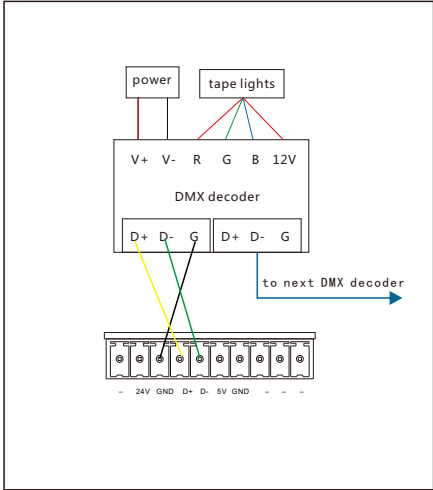

Figure 7.DMX512 intelligent module wiring

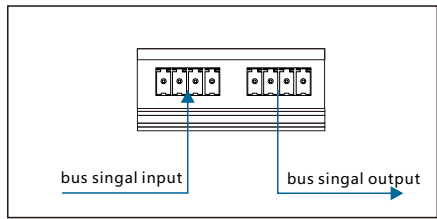

Figure 8. Bus interface wiring instructions



Figure 9



Figure 10

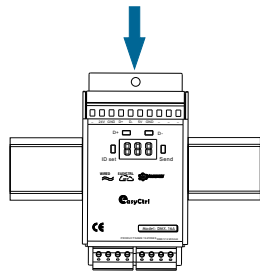

Figure 11

## Technical support

Service Hotline: 86-18029750069

working hours: 9:00-12:00,13:00-18:00,From Monday to Friday)

Email:ceshi@easyctrlgz.com

website: <http://www.easyctrlgz.com>



2025 Guangzhou Easyctrl Intelligent Technology Co., Ltd. All rights reserved.  
This manual may be changed or updated without prior notice.

## Technical Parameters

### Basic Parameters

Operating Voltage	24VDC±10%
Rated Consumption	≤0.4W
Input Voltage	24VDC±10%/5VDC±10%
Signal Path	16 CH DMX512 signal paths
Signal Interface	1 CH DMX512 interface
Bus Interface	bus interface*2
Display Interface	4* light touch function key; 3* digital tube LED light
Protection	NONE

### External Environment

Operating Temperature	-5℃~45℃
Operating Relative Humidity	≤90%
Storage Temperature	-20℃~60℃
Storage Relative Humidity	≤93%

### Product Specifications

Dimensions ( L*W*H )	42 mm*76 mm*32 mm
Net Weight	≤112 g/pcs
Enclosure Material	brushed aluminum shell technology
Installation Method	standard 35mm DIN rail mounting (see Figure 9-11)
Protection Level	NONE

### System Diagram



Notebook



Mobile terminal  
(IOS/Android)

