



YC.KP.06A  
Smart 6-Button Panel(A series ) with Bronze  
Brushed Frame

Product Manual

Release : Oct 13, 2021

Version : V1.1



Figure1.Smart 6-Button Panel

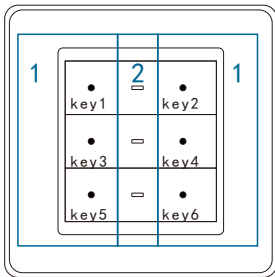

Figure2.Smart 6-Button Panel

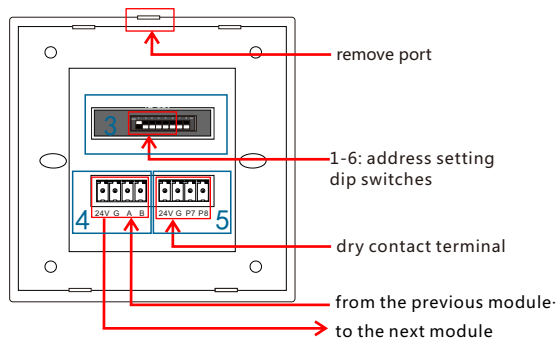
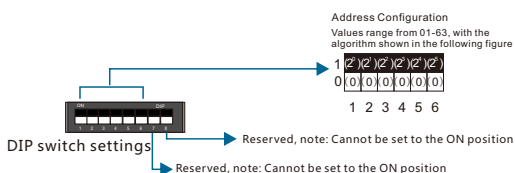

Figure 3. Panel Rear View



ID SET	1	2	3	4	5	6	7	8	ON OFF
ID01									
ID02									
ID03									
ID04									
ID05									
ID06									
ID07									
ID08									
ID09									
ID10									
ID11									
ID12									
ID13									
ID14									
ID15									
ID16									
ID17									
ID18									
ID19									
ID20									
ID21									
ID22									
ID23									
ID24									
ID25									
ID26									
ID27									
ID28									
ID29									
ID30									
ID31									
ID32									
ID33									
ID34									
ID35									
ID36									
ID37									
ID38									
ID39									
ID40									
ID41									
ID42									
ID43									
ID44									
ID45									
ID46									
ID47									
ID48									
ID49									
ID50									
ID51									
ID52									
ID53									
ID54									
ID55									
ID56									
ID57									
ID58									
ID59									
ID60									
ID61									
ID62									
ID63									

Figure 4. Address DIP Switch Table

## Product Overview

Smart 6-Button Panel (see Figure 1), Standard 86 bottom box installation, support seamless connection. Compatible with various materials and colors of faceplates. Features 6 keys, each with an independent LED indicator. Equipped with reset-type tactile switches. Mature structure and stable performance. Constructed from aluminum alloy using stamping and high-gloss finish processes. Available in antique bronze with a brushed finish.. Provides two IO inputs for connecting external sensors,.

## Function Description

- Standard 86 bottom box installation, support seamless connection.
- Provide 6 programmable keys, ICONS can be carved or text screen printing.
- Multi-stage Trigger Control: Supports short press, release after short press, long press, and release after long press actions to control lighting, curtains, scenes, etc.
- Dual Dry Contact Sensor Inputs.
- Sensor Interface Features: Optocoupler isolation with high-voltage/overcurrent protection for exceptional noise immunity and reliability..
- Standard Craftsmanship: Aluminum alloy stamping with high-gloss bronze brushed panel finish.
- Per-key Dual-color LED Indicators: Base-color LED and Activated-color LED.
- Supports RS485/YC-BUS communication.

## Precautions

- Use CAT5E or RVV4\*0.75 four-core wire for bus wiring.
- Do not connect the AB signal of the bus interface incorrectly, otherwise the bus signal will be abnormal.
- After accessing the bus, the panel address cannot be found. Determine whether the address is duplicated. Dial 7 and 8 to be in the OFF position.

## Product Information

Product Dimensions: See Figures 6 and 7

Installation opening size, see Figure 9

Product Information: See Figure 2 and 3

1. Operation keysKey trigger.

2. Panel background indicator.

3. ID Setting:

DIP switch positions 1-6 for address setting (range: 01-63). (See Figure 4)

ID Algorithm:  $ID = A1 \times 2^0 + A2 \times 2^1 + A3 \times 2^2 + A4 \times 2^3 + A5 \times 2^4 + A6 \times 2^5$

Note (See Figure 5): An represents the binary value (0 or 1) of DIP switch position n (n=1~6).

4. Bus Interface: 24V, GND, A, B.

5. Dry Contact Interface: 24V, GND, P7, P8.

## Product Installation

See Figures 11

- Step 1. Disassembly port, use a small knife to pry the gap of the disassembly port can be removed, 4 disassembly port, same as above.
- Step 2. Mounting port, mounting screw with M4\*25, install to the appropriate position.
- Step 3. During installation, check whether the panel is installed in the wrong direction.
- Step 4. After installation, remove the key cover, align it with the hole, and install it properly.

## Safety Warning

- Tightening torque should not exceed 0.4 Nm.
- Installation location: Wall or distribution box
- Do not connect the YC-BUS interface incorrectly, as it may damage the equipment.
- The YC-BUS interface must not be connected to AC power; otherwise, it will damage all devices on the bus.
- Ensure a good ventilation environment.
- Do not expose to rain, contact with other liquids, or corrosive gases.

## Packing List

- Smart key panel\*1/User Manual\*1/Certificate of Conformity\*1

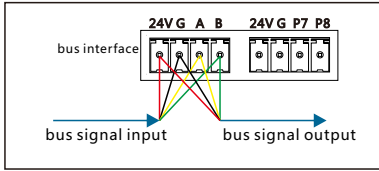

Figure 5. Description of bus interface wiring

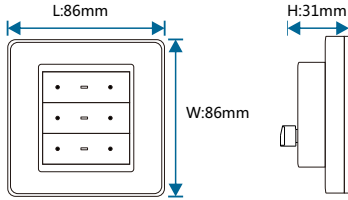

Figure 6. Dimensional Drawing - Front View Figure 7. Dimensional Drawing -Sideview

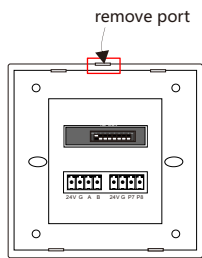

Figure 8. Remove port

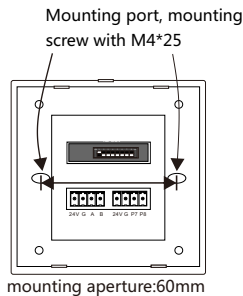

Figure 9. Mounting port

Installation direction, Follow the arrow direction of Figure 10

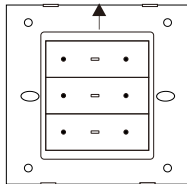

Figure 10. Mounting direction

Figure 11. Disassembly and installation

## Technical support

Service Hotline: 86-18029750069

working hours: 9:00-12:00,13:00-18:00,From Monday to Friday)

Email:ceshi@easyctrlg.com

website: <http://www.easyctrlg.com>



2025 Guangzhou Easyctrl Intelligent Technology Co., Ltd. All rights reserved.  
This manual may be changed or updated without prior notice.

## Technical Parameters

### Basic Parameters

Operating Voltage	24VDC±10%
Operating Power Consumption	0.5W
Standby Power Consumption	0.3W
Number of Keys	six keys
Key Category	reset touch key
Appearance Color/Material	bronze / brushed frame
Bus Interface	bus interface*1
Sensor Interface	dry contact interface*2, providing switch signal input

### External Environment

Operating Temperature	0℃~45℃
Operating Relative Humidity	20% ~ 93% RH
Storage Temperature	-40℃~55℃
Storage Relative Humidity	10% ~ 93% RH

### Product Specifications

Dimensions ( L*W*H )	86mm*86mm*31mm
Net Weight	126g/pcs
Installation Method	standard 86 bottom box mounting(see Figure 9)

### System Diagram



Notebook



Mobile terminal  
(IOS/Android)

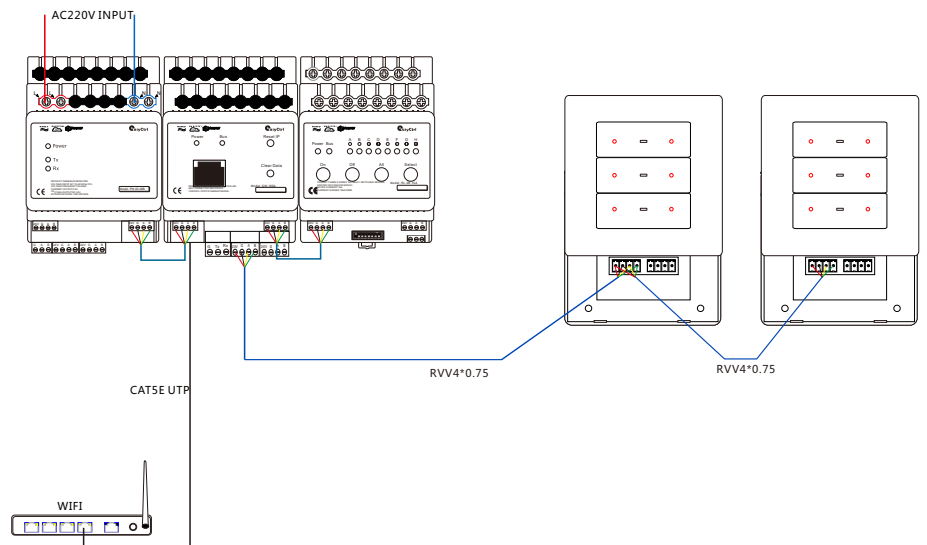

## Bus Specification

Bus interface	4-core wire : RVV4*0.75	UTP : CAT5/CAT5E
24V	RED	BROWN WHITE/BROWN
GND	BLACK	BLUE WHITE/BLUE
A	YELLOW	ORANGE WHITE/GREEN WHITE
B	GREEN	ORANGE/GREEN