



YC.KP.06A

Smart 6-Button Panel(A series ) with Glass Frame

## Product Manual

Release : Oct 13, 2021

Version : V1.1



Figure1.Smart 6-Button Panel

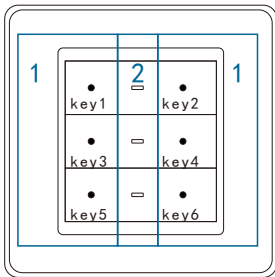

Figure2.Smart 6-Button Panel

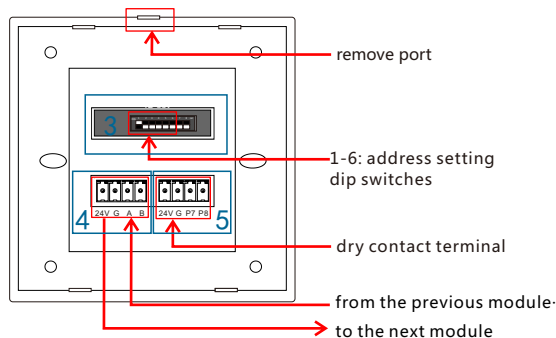
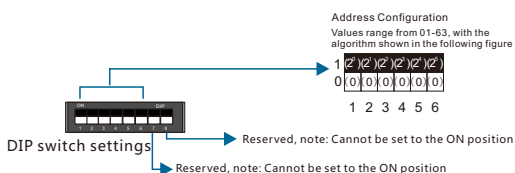

Figure 3. Panel Rear View



ID SET	1	2	3	4	5	6	7	8	ON	OFF
ID01	ID02	ID03	ID04	ID05	ID06	ID07	ID08	ID09	ID10	ID11
ID12	ID13	ID14	ID15	ID16	ID17	ID18	ID19	ID20	ID21	ID22
ID23	ID24	ID25	ID26	ID27	ID28	ID29	ID30	ID31	ID32	ID33
ID34	ID35	ID36	ID37	ID38	ID39	ID40	ID41	ID42	ID43	ID44
ID45	ID46	ID47	ID48	ID49	ID50	ID51	ID52	ID53	ID54	ID55
ID56	ID57	ID58	ID59	ID60	ID61	ID62	ID63	ID64	ID65	ID66
ID67	ID68	ID69	ID70	ID71	ID72	ID73	ID74	ID75	ID76	ID77
ID78	ID79	ID80	ID81	ID82	ID83	ID84	ID85	ID86	ID87	ID88
ID89	ID90	ID91	ID92	ID93	ID94	ID95	ID96	ID97	ID98	ID99

Figure 4. Address DIP Switch Table

## Product Overview

Smart 6-Button Panel (see Figure 1), Standard 86 bottom box installation, support seamless connection. Features 6 keys, each with an independent LED indicator. Equipped with reset-type tactile switches. Mature structure and stable performance. Framed with tempered glass. Provides two IO inputs for connecting external sensors.

## Function Description

- Standard 86 bottom box installation, support seamless connection.
- Provide 6 programmable keys, ICONS can be carved or text screen printing.
- Multi-stage Trigger Control: Supports short press, release after short press, long press, and release after long press actions to control lighting, curtains, scenes, etc.
- Dual Dry Contact Sensor Inputs.
- Sensor Interface Features: Optocoupler isolation with high-voltage/overcurrent protection for exceptional noise immunity and reliability..
- Premium Construction: Glass-bezel panel with industry-standard craftsmanship.
- Per-key Dual-color LED Indicators: Base-color LED and Activated-color LED.
- Supports RS485/YC-BUS communication.

## Precautions

- Use CAT5E or RVV4\*0.75 four-core wire for bus wiring.
- Do not connect the AB signal of the bus interface incorrectly, otherwise the bus signal will be abnormal.
- After accessing the bus, the panel address cannot be found. Determine whether the address is duplicated. Dial 7 and 8 to be in the OFF position.

## Product Information

Product Dimensions: See Figures 6 and 7

Installation opening size, see Figure 9

Product Information: See Figure 2 and 3

1. Operation keysKey trigger.

2. Panel background indicator.

3. ID Setting:

DIP switch positions 1-6 for address setting (range: 01-63). (See Figure 4)

ID Algorithm:  $ID = A1 \times 2^0 + A2 \times 2^1 + A3 \times 2^2 + A4 \times 2^3 + A5 \times 2^4 + A6 \times 2^5$

Note (See Figure 5): An represents the binary value (0 or 1) of DIP switch position n (n=1~6).

4. Bus Interface: 24V, GND, A, B.

5. Dry Contact Interface: 24V, GND, P7, P8.

## Product Installation

See Figures 11

- Step 1. Disassembly port, use a small knife to pry the gap of the disassembly port can be removed, 4 disassembly port, same as above.
- Step 2. Mounting port, mounting screw with M4\*25, install to the appropriate position.
- Step 3. During installation, check whether the panel is installed in the wrong direction.
- Step 4. After installation, remove the key cover, align it with the hole, and install it properly.

## Safety Warning

- Tightening torque should not exceed 0.4 Nm.
- Installation location:Wall or distribution box
- Do not connect the YC-BUS interface incorrectly, as it may damage the equipment.
- The YC-BUS interface must not be connected to AC power; otherwise, it will damage all devices on the bus.
- Ensure a good ventilation environment.
- Do not expose to rain, contact with other liquids, or corrosive gases.

## Packing List

- Smart key panel\*1/User Manual\*1/Certificate of Conformity\*1

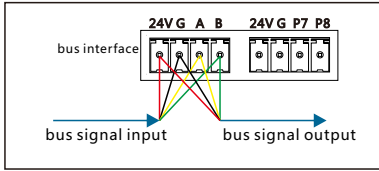

Figure 5. Description of bus interface wiring

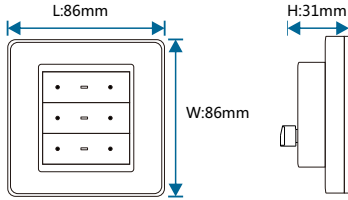

Figure 6. Dimensional Drawing - Front View Figure 7. Dimensional Drawing -Sideview

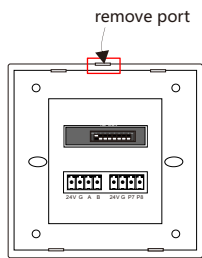

Figure 8. Remove port

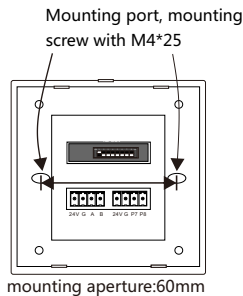

Figure 9. Mounting port

Installation direction, Follow the arrow direction of Figure 10

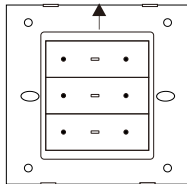

Figure 10. Mounting direction

Figure 11. Disassembly and installation

## Technical support

Service Hotline: 86-18029750069

working hours: 9:00-12:00,13:00-18:00,From Monday to Friday)

Email:ceshi@easyctrlg.com

website: <http://www.easyctrlg.com>



2025 Guangzhou Easyctrl Intelligent Technology Co., Ltd. All rights reserved.  
This manual may be changed or updated without prior notice.

## Technical Parameters

### Basic Parameters

Operating Voltage	24VDC±10%
Operating Power Consumption	0.5W
Standby Power Consumption	0.3W
Number of Keys	six keys
Key Category	reset touch key
Appearance Color/Material	white / glass frame
Bus Interface	bus interface*1
Sensor Interface	dry contact interface*2, providing switch signal input

### External Environment

Operating Temperature	0℃~45℃
Operating Relative Humidity	20% ~ 93% RH
Storage Temperature	-40℃~55℃
Storage Relative Humidity	10% ~ 93% RH

### Product Specifications

Dimensions ( L*W*H )	86mm*86mm*31mm
Net Weight	126g/pcs
Installation Method	standard 86 bottom box mounting(see Figure 9)

### System Diagram



Notebook



Mobile terminal  
(IOS/Android)

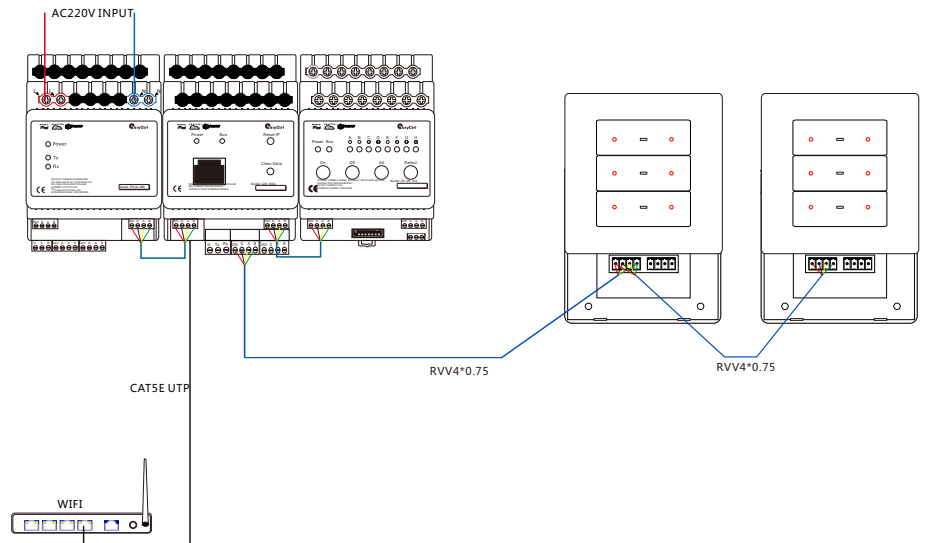

## Bus Specification

Bus interface	4-core wire : RVV4*0.75	UTP : CAT5/CAT5E
24V	RED	BROWN WHITE/BROWN
GND	BLACK	BLUE WHITE/BLUE
A	YELLOW	ORANGE WHITE/GREEN WHITE
B	GREEN	ORANGE/GREEN