

YC-DMX.32A 32 CH DMX Dimming and Color Tuning Module

Product Manual

Release : September 22, 2023

Version : V1.1



Figure 1. 32 CH DMX Dimming and Color Tuning Module

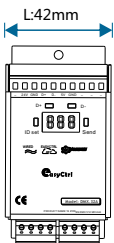

Figure 2. Dimensional Drawing - Front View

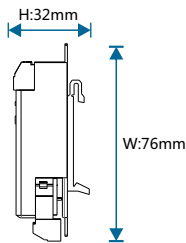

Figure 3. Dimensional Drawing -Sideview

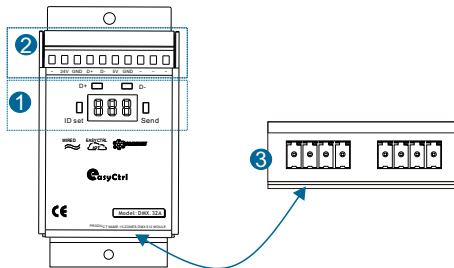

Figure 4. Product Information

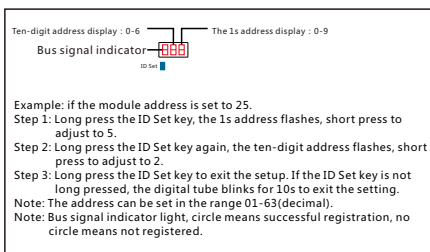

Figure 5. Address setup instructions

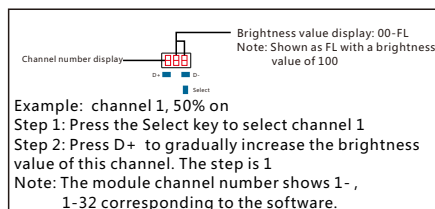

Figure 6. Manually testing data sending

Product Overview

32 CH DMX Dimming and Color Tuning Module (see Figure 1), serve as a system dimmer execution unit, typically installed in a distribution box, rail type or wall-mounted installation, occupies 2.5P module units. It can control 32 DMX channels, real-time feedback of each loop state; Realize the control of RGB light switch, dimmer, color matching, DMX wall washing lamp, moving head lamp and other equipment.

Function Description

- Standard 35mm DIN rail installation: Occupies 2.5P module units.
- Provide 32 sets of DMX512 signal address, each channel can independently control 0-100 brightness value, and with feedback
- Returns the actual DMX dimmer status of each circuit to the monitoring center immediately after executing scene commands.
- With local and remote programming and testing functions.
- Supports online firmware updates and Bus network disconnection alarm function.
- Supports YC-BUS communication.

Precautions

- Use RVV4*0.75 four-core wire for bus wiring.
- Do not connect the D+ and D- signals of the bus interface incorrectly; otherwise, the bus signals will be abnormal.

Product Information

Product Dimensions: See Figures 2 and 3

Product Wiring: See Figure 7 and 8

Product Information: See Figure 4

1. Function Keys:

- ID Set key : Address setting 01-63, setting method (see Figure 5).
- D+ key : Long press the brightness value gradually increase.
- D- key : Long press the brightness value gradually decreasing.
- Select key : Short press to select the DMX512 channel.

2. DMX512 interface : 24V and 5V are the output voltages (see Figure 7).

3. Bus interface (see Figure 8) :

- Bus interface line sequence: 24V, GNG, A, B

Product Installation

See Figures 9-11

- Step 1. Secure the 35mm rail with screws.
- Step 2. Hold the 32 CH DMX Dimming and Color Tuning Module at a 45 degree angle with both hands, and the bottom of the module is clamped against the guide rail. The whole module is pressed to the guide rail at a 90 degree angle, and the module is slid until it is in the correct position.

Safety Warning



- Tightening torque should not exceed 0.4 Nm.
- Installation location: Distribution box.
- Do not connect the YC-BUS interface incorrectly, as it may damage the equipment.
- The YC-BUS interface must not be connected to AC power; otherwise, it will damage all devices on the bus.
- Ensure a good ventilation environment.
- Do not expose to rain, contact with other liquids, or corrosive gases.

Packing List

- YC-DMX.32A*1/User Manual*1/Certificate of Conformity*1

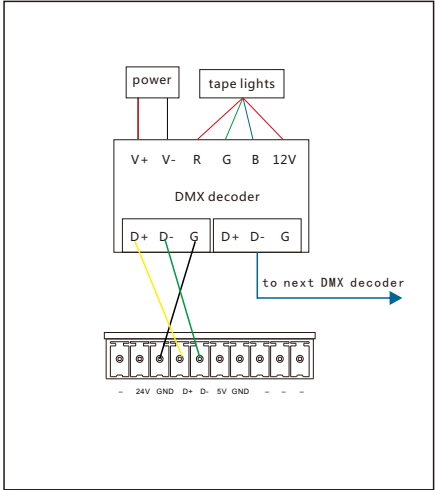

Figure 7.DMX512 intelligent module wiring

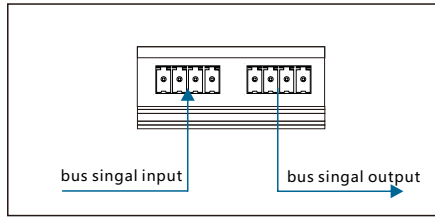

Figure 8. Bus interface wiring instructions



Figure 9

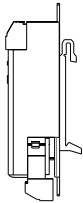

Figure 10

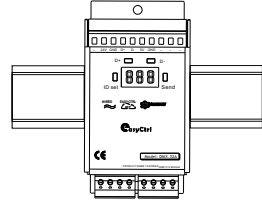

Figure 11

Technical support

Service Hotline: 86-18029750069

working hours: 9:00-12:00,13:00-18:00,From Monday to Friday)

Email:ceshi@easyctrlgz.com

website: <http://www.easyctrlgz.com>



2025 Guangzhou Easyctrl Intelligent Technology Co., Ltd. All rights reserved.
This manual may be changed or updated without prior notice.

Technical Parameters

Basic Parameters	
Operating Voltage	24VDC±10%
Rated Consumption	≤0.4W
Input Voltage	24VDC±10%/5VDC±10%
Signal Path	32 CH DMX512 signal paths
Signal Interface	1 CH DMX512 interface
Bus Interface	bus interface*2
Display Interface	4× light touch function key; 3× digital tube LED light
Protection	NONE

External Environment	
Operating Temperature	-5℃~45℃
Operating Relative Humidity	≤90%
Storage Temperature	-20℃~60℃
Storage Relative Humidity	≤93%

Product Specifications	
Dimensions (L*W*H)	42 mm*76 mm*32 mm
Net Weight	≤112 g/pcs
Enclosure Material	brushed aluminum shell technology
Installation Method	standard 35mm DIN rail mounting (see Figure 9-11)
Protection Level	NONE

System Diagram



Notebook



Mobile terminal
(IOS/Android)

