



YC-CL.04.02A
2 CH Curtain Module

Product Manual

Release : September 22, 2023
Version : V1.2



Figure 1. 2 CH Curtain Module

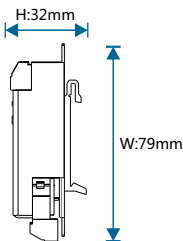
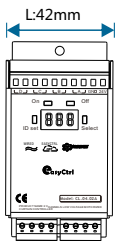

Figure 2. Dimensional Drawing - Front View Figure 3. Dimensional Drawing -Sideview

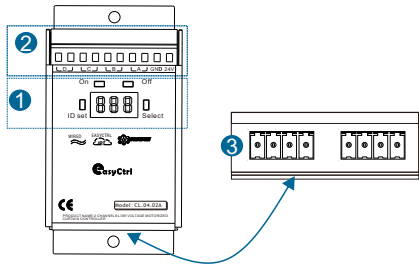

Figure 4. Product Information

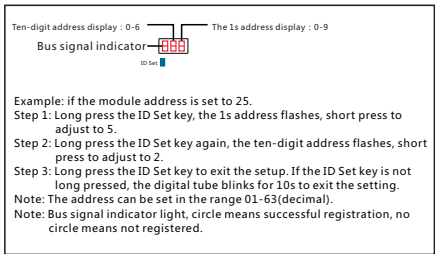

Figure 5. Address setup instructions

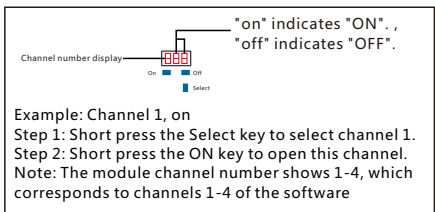

Figure 6. Manually testing the curtain switch

Product Overview

The 2 CH Curtain Module (see Figure 1) serves as a system execution unit, typically installed in a distribution box, rail type or wall-mounted installation, occupies 2.5P module units. It can also be installed in the 86 bottom box, used to control the dry contact curtain to open, close, such as Dua, Aoko, Changming dry contact curtain.

Function Description

- Standard 35mm DIN rail installation: Occupies 4P module units.
- Provide two sets of curtain interface, can control two curtains.
- Returns the actual curtain status of each circuit to the monitoring center immediately after executing scene commands.
- With the status of digital tube LED light, curtain status at a glance.
- With local and remote programming and testing functions.
- Supports online firmware updates and Bus network disconnection alarm function.
- Supports YC-BUS communication.

Precautions

- Use RVV4*0.75 four-core wire for bus wiring.
- Do not connect the AB signal of the bus interface incorrectly; otherwise, the bus signal is abnormal.
- A-D channel access load, do not exceed 30V, otherwise it will burn the equipment.

Product Information

Product Dimensions: See Figures 2 and 3

Product Wiring: See Figure 7 and 8

Product Information: See Figure 4

1. Function Keys:

- ID Set key : Address setting 01-63, setting method (see Figure 5)
- On key : Press the corresponding curtain channel to open.
- Off key : Press the corresponding curtain channel to close.
- Select key : Short press to select the curtain channel.

2. Curtain interface: A, B, C, D corresponding to 1-4 channels, 24V, GND output voltage, (see Figure 7)

3. Bus interface (see Figure 8) :

- Bus interface sequence: 24V, GND, A, B

Product Installation

See Figures 9-11

- Step 1. Secure the 35mm rail with screws.
- Step 2. Hold the 2 ch low voltage motorized curtain controller at a 45 degree angle with both hands, and the bottom of the module is clamped against the guide rail. The whole module is pressed to the guide rail at a 90 degree angle, and the module is slid until it is in the correct position.

Safety Warning



- Tightening torque should not exceed 0.4 Nm.
- Installation location: Distribution box.
- Do not connect the YC-BUS interface incorrectly, as it may damage the equipment.
- The YC-BUS interface must not be connected to AC power; otherwise, it will damage all devices on the bus.
- Ensure a good ventilation environment.
- Do not expose to rain, contact with other liquids, or corrosive gases.

Packing List

- YC-CL.04.02A*1/User Manual*1/Certificate of Conformity*1

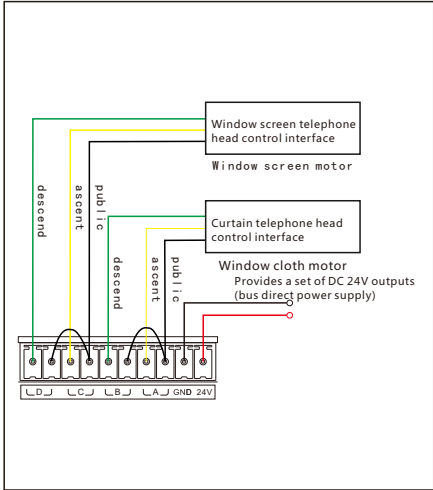

Figure 7. Curtain interface wiring

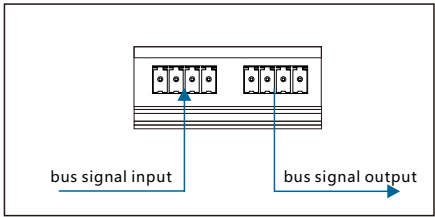

Figure 8. Description of bus interface wiring



Figure 9

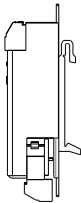

Figure 10

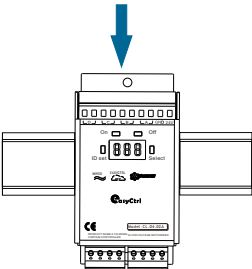

Figure 11

Technical support

Service Hotline: 86-18029750069

working hours: 9:00-12:00,13:00-18:00,From Monday to Friday)

Email:ceshi@easyctrlg.com

website: http://www.easyctrlg.com



2025 Guangzhou Easyctrl Intelligent Technology Co., Ltd. All rights reserved.
This manual may be changed or updated without prior notice.

Technical Parameters

Basic Parameters	
Operating Voltage	24VDC±10%
Rated Consumption	≤0.4W
Input Voltage	24VDC±10%
Curtain Circuit	2 sets of curtains
Load Contact	28V
Bus Interface	bus interface*2
Display Interface	4* light touch function key; 3* digital tube LED light
Protection	NONE
External Environment	
Operating Temperature	-5℃~45℃
Operating Relative Humidity	≤90%
Storage Temperature	-20℃~60℃
Storage Relative Humidity	≤93%
Product Specifications	
Dimensions (L*W*H)	42 mm*76 mm*32 mm
Net Weight	≤112 g/pcs
Enclosure Material	brushed aluminum shell technology
Installation Method	standard 35mm DIN rail mounting (see Figure 9-11)
Protection Level	NONE
System Diagram	



Notebook



Mobile terminal
(iOS/Android)

